

## DESCALING

Limescale normally builds up with the use of the appliance.

The machine must be descaled when the icon appears on the display.

**i** **Important note: It is recommended to refer to the next section, "Remarks on Descaling", for some tips about keeping the machine in perfect working order.**

**i** **Do not turn the machine off or put it in stand-by mode during the descaling process.**

**i** **Only use the Saeco descaling solution. Its formula has been designed to ensure better machine performance and operation for its whole operating life. If correctly used, it also avoids alterations in the brewed product.**

**!** **Warning! Never drink the descaling solution or any products dispensed until the cycle has been carried out to the end. Never use vinegar as a descaling solution.**

Before descaling, remove the Pannarello (if supplied) from the steam wand as described in the "Cleaning and Maintenance" section.

- Turn the machine on by pressing the "STAND-BY" button. **Wait for the machine to finish its rinse cycle and warm up.**

**!** **Warning! Remove the "Intenza" filter (if installed) before adding the descaling solution.**

- Pour the entire content of the Saeco concentrated descaling solution into the water tank, and then fill the tank with fresh drinking water up to the MAX level. Place the tank back in the machine.

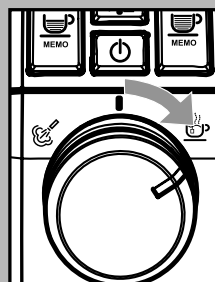
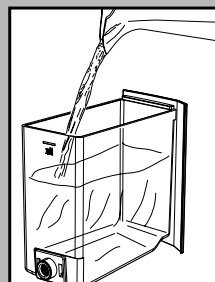
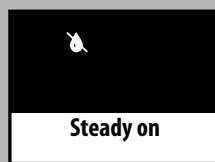
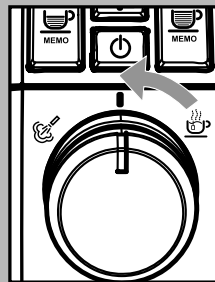
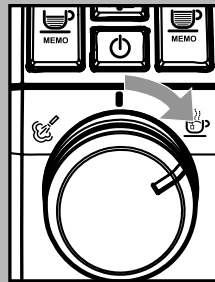
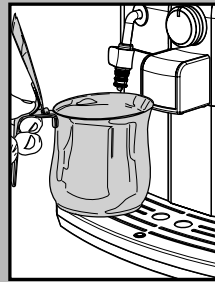
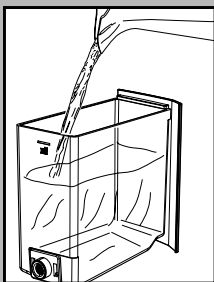
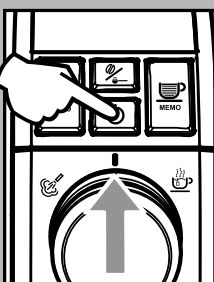
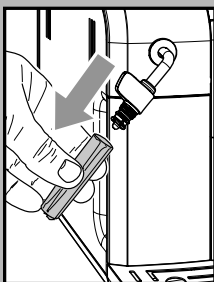
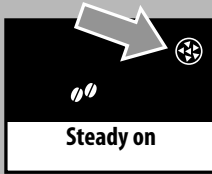

1 Place a container below the steam wand.

**i** **Use a container of at least 1 litre capacity. If you do not have a container of this capacity, once it is filled close the knob, empty the container and then place it again under the wand and repeat the procedure.**

2 Only after adding the descaling solution in the tank, turn the selector switch clockwise to position "☕", and then dispense 2-3 cups of water (approx. 150 ml).

3 Stop dispensing by turning the selector switch back to its central position "0".

4 Allow the descaling solution to work for 10 minutes.

5 Repeat steps 2 and 3 at intervals of 3 minutes, until there is no descaling solution left in the water tank.

6 When the icon is displayed, rinse the water tank thoroughly and refill it with fresh drinking water.

7 Empty the container used to collect the liquid dispensed by the machine and place it under the steam wand.

8 Turn the selector switch clockwise to set it to the "☕" position. The machine rinse cycle starts.

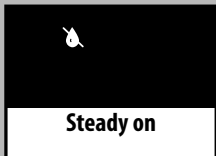

- 9 When the water in the tank is finished, the icon on the side is displayed to indicate that the selector switch must be brought back to the "0" position.

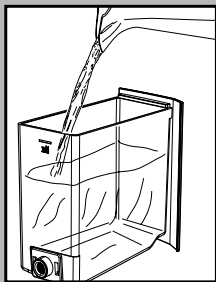
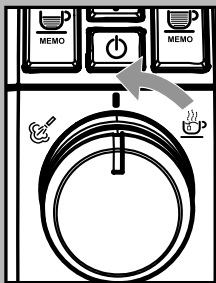

- 10 Rinse the water tank thoroughly and refill it with fresh drinking water.  
11 Empty the container used to collect the liquid dispensed by the machine.

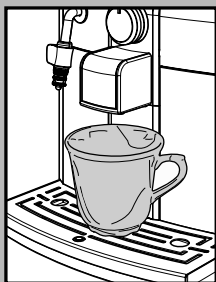

- 12 Place a large container under the dispensing spout.

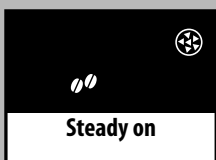

- 13 Before starting the procedure, check that the following icons are displayed.

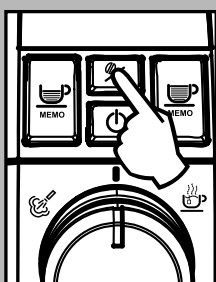

- 14 Select the pre-ground coffee function by pressing the "☕" button one or more times.

**i** Do not add the pre-ground coffee to the compartment.

The icon will appear on the display.



- 15 Press the button to brew a long coffee.

- 16 Wait until brewing is completed and empty the container with water.

- 17 Repeat the operations from step 12 to step 16 for 3 times; then continue with step 18.

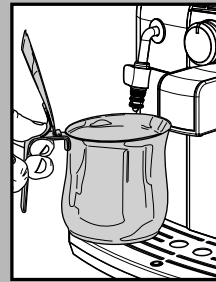

- 18 Place a container under the steam wand (Pannarello, if supplied).

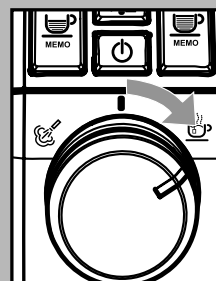

- 19 Turn the selector switch clockwise to set it to the "☕" position.

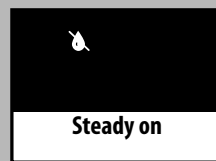

- 20 Dispense water until the no water signal is displayed, then turn the selector switch counter-clockwise to set it to the "0" position.

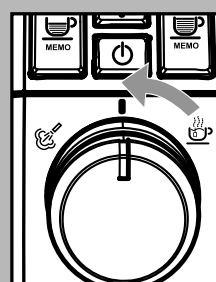

- 21 At the end, fill the water tank again.

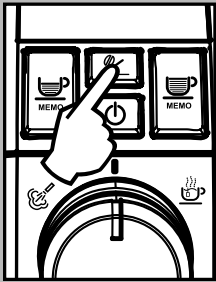

22 Hold the “MEMO” button pressed for 6 seconds to reset the machine and cancel the descaling alarm signal. The light “MEMO” turns off.

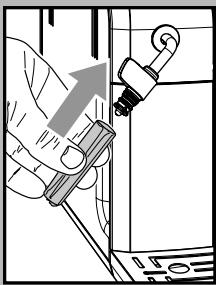

Reassemble the external part of the Panarello.

The descaling cycle is complete. Then, the products can be brewed.

**i** If the machine is switched off during the descaling cycle, next time the machine is switched on the cycle must be repeated from the beginning.

**i** The descaling solution must be disposed of according to the manufacturer’s instructions and/or regulations in force in the country of use.

**i** After completing the descaling cycle, wash the brew group as described in the “Brew Group” section in the “Cleaning and maintenance” section.

## Remarks on Descaling

The previous section explains the correct operations to perform to descale the machine.

The machine you have purchased is equipped with advanced software to check the quantity of used water in order to provide reliable information about the right time to carry out descaling operations.

This software has been programmed for standard water hardness.

In case of especially hard water (high calcium content), descaling cycles might have to be carried out more frequently, even if the machine does not display warning signals.

Even if the machine is not used often (e.g. 1 coffee per day), it is recommended to perform descaling cycles more frequently.

In these specific cases, it is recommended to perform descaling cycles every 1-2 months, even if the machine does not signal it.